

Review, Respond and Relate

Integrating Research, Policy and Practice Around the World

PROGRAM AT-A-GLANCE

THURSDAY, APRIL 19

LOCATION

| | | |
|-----------|---|-------------------|
| 7:15 am | Parent Breakfast | Grouse |
| 8:00 am | Registration Open | Foyer |
| 8:30 am | Welcome <i>Jan Lutke</i> | Ballroom |
| | Opening Remarks: the Wisdom of Experience: <i>Change Makers</i> <i>Myles Himmelreich, CJ Lutke, Katrina Griffin</i> | Ballroom |
| | Remarks: Nothing About Us Without Us: <i>Change Makers</i> <i>RJ Formanek</i> | Ballroom |
| | Conference Keynote: Understanding How "Executive Function" IS "Everyday Function" in FASD <i>Sara Jo Nixon</i> | Ballroom |
| 10:05 am | Presentation of the CanFASD Dr. Sterling Clarren FASD Research Award <i>Presented by Dr. Sterling Clarren & Audrey McFarlane</i> | Ballroom |
| 10:10 am | Break – Exhibits Open & Poster Viewing | Foyer & Regency A |
| 10:40 am | CONCURRENT SESSION A | |
| A1 | 3 ORAL PAPERS | |
| A1a | Fetal Alcohol Exposure Impairs Blood Flow and Stroke Recovery in Adult Mouse <i>Shameena Bake</i> | Plaza C |
| A1b | Sex Differences in Biochemical but Not Behavioral Responses to Delay Fear... <i>Kevin Caldwell</i> | Plaza C |
| A1c | Prenatal Alcohol Exposure Affects the Early Postnatal Stress and Immune... <i>Andrea Allan</i> | Plaza C |
| A2 | A Clinical Pathway for individuals with FASD and Mental Health/Addictions... <i>Tara Anderson, Mansfield Meia</i> | Regency D |
| A3 | Towards Healthy Outcomes for Individuals with FASD... <i>Aamena Kapasi, Jacqueline Pei</i> | Regency C |
| A4 | The Biographic Screening Interview for Adults with FASD (BSI-FASD) <i>Lina Schwerg, Sandra Marla Ahlert</i> | Plaza A |
| A5 | TWO 45-MINUTE SESSIONS | |
| A5a | Creation of an FASD Community Coalition <i>Yvette Kraychy, Sharon Britnell, Cindy Olchoway</i> | Regency EF |
| A5b | LIVE (Living Indigenous Values Everyday) <i>Sherry LeTendre, Donna Kristiansen, Sandra Bruno, Robin Roan-Alexis</i> | Regency EF |
| A6 | FASD is a Whole Body Diagnosis, Part 1: Bowel and Allergy Problems <i>Rod Densmore</i> | Georgia AB |
| A7 | TWO 45-MINUTE SESSIONS | |
| A7a | From Service User to Service Provider: My Life on Both Sides of the System <i>Shawn Woodhouse</i> | Plaza B |
| A7b | Using FASD Informed Strategies in a Less Informed World <i>Clare Mitchell, Sarah Davison, Natalie Davison, Angela Geddes</i> | Plaza B |
| A8 | Hope and Living Life with FASD <i>Tanya Northcott</i> | Prince of Wales |

THURSDAY, APRIL 19, CONT.

LOCATION

| | | |
|-----------|---|-------------------|
| 12:10 pm | Lunch (provided) – Poster Session & Exhibits Open | Foyer & Regency A |
| 1:10 pm | Remarks: Nothing About Us Without Us: <i>Change Makers</i> <i>Paul Thompson</i> | Ballroom |
| | Will Diagnostic Systems for FASD in Children Work in Adults? <i>Kenneth L. Jones, Jocelynn Cook, Jonathan Down, R. Colin Carter</i> | Ballroom |
| 3:15 pm | Break – Exhibits Open & Poster Viewing | Foyer & Regency A |
| 3:45 pm | CONCURRENT SESSION B | |
| B1 | 3 ORAL PAPERS | |
| B1a | Development of Descriptive Profiles and Recognition Cues to Improve... <i>Mansfield Mela, Tara Anderson</i> | Plaza C |
| B1b | Improving Outcomes for Youth and Young Adults with FASD... <i>Dan Dubovsky</i> | Plaza C |
| B1c | A Clinician's Perspective of Crisis Intervention with Individuals with FASD <i>Andrew Wilson, Irene Carter</i> | Plaza C |
| B2 | Assessing FASD and Transitional Youth—Diagnostic, Management... <i>Melody Hawdon, Pablo Sanhueza</i> | Plaza A |
| B3 | Diagnosis: Why It's Never Too Late! <i>Glenda Jansen, Paul Thompson</i> | Regency EF |
| B4 | Educational and Behavioral Interventions for Adolescents with FASD <i>Ira Chasnoff</i> | Regency C |
| B5 | The Developmental Trajectory of Executive Functioning and Adaptive... <i>Allison McNeil, Jacqueline Pei</i> | Regency D |
| B6 | FASD is a Whole Body Diagnosis, Part 2: Rheumatoid Arthritis, Asthma... <i>Rod Densmore</i> | Georgia AB |
| B7 | TWO SESSIONS | |
| B7a | Assessing Executive Function in an Adolescent PAE Population... <i>Leah Enns</i> | Plaza B |
| B7b | Listening Difficulties, Social Reciprocity, and Social Communication... <i>Susan McLaughlin, John Thorne</i> | Plaza B |

FRIDAY, APRIL 20

| | | |
|----------|--|-------------------|
| 8:00 am | Registration Open | Foyer |
| 8:30 am | Remarks: Nothing About Us Without Us: <i>Change Makers</i> <i>Katrina Griffin</i> | Ballroom |
| | Plenary: DOHAD: Metabolic Symposium - Updates in Animal and Human Research | Ballroom |
| | FASD in Adulthood: Insights on Metabolic Syndrome Risk from Zebrafish Models <i>Olivia Weeks</i> | Ballroom |
| | Does PAE Increase Offspring Risk for Metabolic Syndrome? Metabolic Assessment in Moderate PAE Mouse Model <i>Susan Smith</i> | Ballroom |
| | PAE and Metabolic Disease in Adulthood: Evidence From Animal Models <i>Karen Moritz</i> | Ballroom |
| | Associations Between Prenatal Alcohol Exposure, Behavior, Diet, and Obesity <i>Jeff Wozniak</i> | Ballroom |
| 10:30 am | Break – Exhibits Open & Poster Viewing | Foyer & Regency A |

| | | |
|-----------|---|-------------------|
| 11:00 am | Remarks: Nothing About Us Without Us: <i>Change Makers</i> <i>Alexandra Taussig</i> | Ballroom |
| | Plenary: Community Based Research Starts with the Community: On Effective and Ethical Practices for “Patient-Oriented” and Collaborative Research with Families and Individuals with FASD <i>Dorothy Reid, Lisa Brownstone, Michelle Stewart, Niall Schofield</i> | Ballroom |
| 12:00 pm | Lunch (on your own) & Exhibits Open | Foyer & Regency A |
| 1:15 pm | CONCURRENT SESSION C | |
| C1 | 3 ORAL PAPERS | |
| C1a | Everyday Life and FASD: A Weekend Break for Adults Affected by FASD... <i>Alison Frieling, Gisela Michalowski</i> | Plaza C |
| C1b | Beacon Aotearoa: Shining a Light on FASD and Neurodisability <i>Lisa Smith, Kim Milne</i> | Plaza C |
| C1c | Quality of Life for Alaskan Individuals with Fetal Alcohol Spectrum... <i>Brenda Dow</i> | Plaza C |
| C2 | 3 ORAL PAPERS | Plaza A |
| C2a | The CICADA Centre NSW: A Lifespan Approach to Providing Care... <i>Marcel Zimmet, Bronwyn Milne</i> | Plaza A |
| C2b | Fetal Alcohol Resource Program Pilot Project: Innovative Model of... <i>Janet Carioni, Nancy Lockwood, Maude Champagne</i> | Plaza A |
| C2c | Innovative Cross-disciplinary Partnership Enables Rapid... <i>Enid Watson, Robert Kinscherff</i> | Plaza A |
| C3 | FASD and Child Welfare Practice - A Focus on Life Course Theory <i>Dorothy Badry, Lenora Marcellus</i> | Regency D |
| C4 | Nothing About Us Without Us: What do Families and Individuals Need... <i>Dorothy Reid, Lisa Brownstone, Michelle Stewart, Niall Schofield</i> | Regency C |
| C5 | Creating and Maintaining a Positive Focused System of Care <i>Dan Dubovsky</i> | Regency EF |
| C6 | TWO 45-MINUTE SESSIONS | |
| C6a | Service Utilisation Patterns of Individuals with FASD: An Analysis... <i>Xinjie Cui</i> | Plaza B |
| C6b | Clinical Observations Regarding the Gaps in Services Faced by Adults... <i>Paige Irwin</i> | Plaza B |
| C7 | TWO 45-MINUTE SESSIONS | |
| C7a | Assessment Profiles of a Community-Based Cohort of Adults with... <i>Paul Jerry, Louisa Clapper</i> | Georgia AB |
| C7b | Profiles of Adolescents and Adults with FASD: Results from the FASD... <i>Jocelynn Cook, Kelly Harding, Kathy Unsworth</i> | Georgia AB |
| 2:45 pm | Break – Exhibits Open & Poster Viewing | Foyer & Regency A |



FRIDAY, APRIL 20, CONT.

LOCATION

3:15 pm

CONCURRENT SESSION D

D1

3 ORAL PAPERS

D1a

Supporting Employment Success in Adults with FASD
Aamena Kapasi

Plaza C

D1b

Living Accommodation for People Affected by FASD: A Study Carried out...
Alison Frieling, Gisela Michalowski

Plaza C

D1c

"Well Where's He Supposed to Live?": Experiences of Adoptive Parents...
Shelley Watson, Kelly Harding

Plaza C

D2

Generating Dialogue for Self-Understanding and System Navigation...
Allison Pooley, Michelle Stewart, Paul Gordon

Regency D

D3

Mapping the Undiscovered Country: Physical and Mental Health in Adults...
Claire D. Coles, Therese Grant, Joanne Weinberg

Regency C

D4

Towards a Regional and Community FASD/Brain Disorder "Eco-System"
J. Douglas Salmon, Heather Pickin, Jonathan Rudin

Plaza B

D5

TWO 45-MINUTE SESSIONS

D5a

FASD & Group Facilitation with Youth & Young Adults
Colleen Hook, Brittany Durant

Regency EF

D5b

Action Hall Support Groups for Adults with FASD
Myles Himmelreich, Bernadette O'Donnell

Regency EF

D6

The SAFTHON: Making the Invisible Visible — Reunion Island
Joëlle Balanche, Denis Lamblin

Plaza A

D7

Description of the First Psychotropic Medication Algorithm for Individuals...
Mansfield Mela, Dorothy Reid, Ana Hanlon-Deerman, Rod Densmore

Georgia AB

D8

Aging with FASD—Diagnostic and Management Considerations:...
Melody Hawdon, Pablo Sanhueza

Prince of Wales

SATURDAY, APRIL 21

8:00 am

Registration Open

Foyer

8:30 am

Remarks: Nothing About Us Without Us: Change Makers
Justin Mitchell

Ballroom

Plenary: FASD and the Criminal Justice system: Making the Case for Research to Build Evidence-Based Policy Responses
Kaitlyn McLachlan
PANEL: *Joanna Wells, Mansfield Mela, Corey La Berge*

Ballroom

9:40 am

Break – Exhibits Open & Poster Viewing

Foyer & Regency A

10:10 am

CONCURRENT SESSION E

E1

3 ORAL PAPERS

E1a

Influence of Small Doses of Alcohol on Fetuses and Newborns
Anait Marianian

Plaza C

E1b

A New Population-Level Data Source for Research in Adults with FASD...
Alexandra Bonardi

Plaza C

E1c

The Effects of Maternal Alcohol Use and Smoking on Children's Mental...
Madeleine Benjamin

Plaza C

| | | |
|-----------|---|-------------------|
| E2 | PRESENTATIONS BY THE RECIPIENTS OF THE DR. STERLING CLARREN AWARD (TWO 45-MINUTE SESSIONS) | |
| E2a | Magnetic Resonance Imaging (MRI) of Brain Development in FASD <i>Sarah Treit</i> | Georgia AB |
| E2b | Utilizing Administrative Data to Enhance Population Based FASD... <i>Deepa Singal</i> | Georgia AB |
| E3 | FASD Youth Housing Pilot Project Preliminary Results <i>Sandi Pineda-Selva, Angela Kneé</i> | Plaza A |
| E4 | Self-Regulation Among Adolescents with FASD and the Impact... <i>Jacqueline Pei, Aamena Kapasi</i> | Regency C |
| E5 | Co-Occurring vs. Multi-Occurring Mental Health Diagnoses... <i>Ira Chasnoff</i> | Regency EF |
| E6 | What We Say Matters: Key Stakeholder Perspectives on Public... <i>John Aspler</i> | Prince of Wales |
| E7 | TWO 45-MINUTE SESSIONS | |
| E7a | FASD and the Youth Criminal Justice System <i>Pat Yuzwenko, Nicole Mizzi</i> | Regency D |
| E7b | FASD Justice Support Program for Youth <i>Chris Leptich, Michael Stansberry, Nicole Mizzi</i> | Regency D |
| E8 | Playing to Our Strengths - a Hands-on Workshop Using Improv to Support... <i>Michelle Stewart, Rebecca Caines</i> | Plaza B |
| 11:40 am | Lunch (Provided) & Exhibits Open | Foyer & Regency A |
| 12:45 pm | Closing Plenary: Parents with FASD: Challenging the Stereotypes <i>Peter Choate</i> | Ballroom |
| | Closing Plenary Panel: We Are Parents: What It Looks Like <i>RJ Formanek, Myles Himmelreich, Angie Lutke, Sebrina Mikkul, Justin Mitchell, Erin Reimer-Mayzes</i> | Ballroom |
| | Presentation of the Starfish Award | Ballroom |
| | Closing Ceremonies: Nothing About Us Without Us: <i>Change Makers</i> | Ballroom |
| 3:00 pm | Adjourn | |

POSTER LISTING

POSTER SESSION | Thursday, April 18, 2018, 12:20 pm – 1:00 pm

P1 | "I Feel that I Need More Knowledge and Experience": Health Care Students' Self-Efficacy Addressing Fetal Alcohol Spectrum Disorder in Primary Care

Kelly Harding, PhD, Research Coordinator and Research Assistant, Canada FASD Research Network; Adjunct Professor, Department of Psychology, Laurentian University, Sudbury, ON, Canada

Shelley Watson, PhD, Acting Associate Vice-President, Learning and Teaching, Centre for Academic Excellence, Laurentian University; Professor, Department of Psychology, Laurentian University, Sudbury, ON, Canada

P2 | Prenatal Alcohol and Other Drug Exposures in the Child Welfare System: Working to Improve Identification and Care

Heather McCann, MPH, CPH, MCHES, Health Scientist Fellow, CDC, Atlanta, GA, USA

P3 | Children in Care: Co-Morbid Psychiatric Diagnoses and Assessments of Children Referred for FASD Assessments at the Children's Aid Society of Toronto

Mitesh Patel, FRCP, Physician, Centre for Addiction and Mental Health, University of Toronto, Toronto, ON, Canada

P4 | Youth Offenders with Fetal Alcohol Spectrum Disorder in New Zealand: Addressing Gaps in Support

Kesia Sherwood, PhD Candidate, University Of Otago, Wellington, New Zealand

P5 | Adolescent Substance Use Screening and Intervention: A Practical Implementation Guide for Pediatricians

Natasha Singh, MPA, Public Health Analyst, Centers For Disease Control And Prevention, Atlanta, GA, USA

Expert Planning Committee

Jan Lutke, Conference Chair, Vancouver, BC, Canada

Tina Antrobus, MA, RCC, Registered Clinical Counselor, PLEA Community Services, Coquitlam, BC, Canada

Michael Charness, MD, Chief of Staff, VA Boston Healthcare System; Faculty Associate Dean, Professor of Neurology, Harvard Medical School; Associate Dean, Professor of Neurology, Boston University School of Medicine, West Roxbury, MA, USA

Peter W. Choate, PhD, Associate Professor, Social Work, Mount Royal University, Calgary, AB, Canada

Dan Dubovsky, MSW, FASD Specialist, Philadelphia, PA, USA

Bill Dunty, PhD, Program Director, Division of Metabolism and Health Effects, National Institute on Alcohol Abuse and Alcoholism, National Institutes of Health, Bethesda, MD, USA

Kristina Hiemstra, Director, UBC Interprofessional Continuing Education, University of British Columbia, Vancouver, BC, Canada

Brenda Knight, Registered Psychologist, Private Practice, Vancouver, BC, Canada

Christine Loock, MD, FRCP, Associate Professor, Department of Pediatrics, University of British Columbia; Responsive Intersectoral Community Health, Education, and Research (RICHER) Initiative, BC Children's Hospital & Sunny Hill Health Centre for Children, Vancouver, BC, Canada

Edward Riley, PhD, Distinguished Research Professor, Center for Behavioral Teratology, San Diego State University, San Diego, CA, USA

Joanne Weinberg, PhD, Professor and Distinguished University Scholar, Emerita, Department of Cellular & Physiological Sciences, University of British Columbia, Vancouver, BC, Canada

FASD Leadership Committee

Katrina Griffin, Early Childhood Educator, Adult Leadership Committee, Vancouver, BC

Myles Himmelreich, FASD Consultant, Motivational Speaker, Adult Leadership Committee, Vancouver, BC

CJ Lutke, Speaker, Mentor, Adult Leadership Committee, Vancouver, BC

Expert Advisory Committee

Sally M. Anderson, PhD, FASD Activities Coordinator, Interagency Coordinating Committee on Fetal Alcohol Spectrum Disorders, National Institute on Alcohol Abuse and Alcoholism, National Institutes of Health, Bethesda, MD, USA

Ilona Autti-Rämö, MD, Medical Director, Insurance Medicine Unit, The Social Insurance Institute, Health Benefits, Adjunct Professor at the Child Neurology Department, Helsinki University Hospital, Finland

Dorothy Badry, PhD, RSW, Associate Professor, Faculty of Social Work, University of Calgary, Calgary, AB, Canada

Tatiana Balachova, PhD, Associate Professor, Co-Director, Interdisciplinary Training Program in Child Abuse and Neglect (ITP), Department of Pediatrics, The University of Oklahoma Health Sciences Center, Oklahoma City, OK, USA

Diane Black, PhD, FAS Foundation of the Netherlands, Uithuizen, the Netherlands; Chair, European FASD Alliance, Landskrona, Sweden

Paul D. Connor, PhD, Neuropsychologist, Private Practice and Courtesy Clinical Assistant Professor, Fetal Alcohol and Drug Unit, University of Washington, Seattle, WA, USA

Lori Vitale Cox, PhD, Clinical Coordinator, Eastern Door Diagnostic Team for FASD and Related Conditions; Director, Nogemag Healing Lodge for Youth, Rexton, NB, Canada

Elizabeth Elliott, AM, MD, MPhil, MBBS, FRACP, FRCPCH, FRCP, Child and Adolescent Health, Sydney Medical School, University of Sydney; and The Sydney Children's Hospitals Network, Westmead, Sydney, Australia

Emily Fitzpatrick, Student Representative; MBBS, PhD Candidate, Paediatric Registrar, Discipline of Paediatrics and Child Health, Sydney Medical School, Sydney, Australia

James P. Fitzpatrick, FRACP, MBBS, BSc, PhD, Paediatrician, Director Alcohol and Pregnancy and FASD Research, Telethon Kids Institute; Director PATCHES Paediatrics, Subiaco, Australia

Erikson F. Furtado, MD, PhD, University of Sao Paulo, School of Medicine of Ribeirão Preto, Department of Neurosciences and Behavior, Division of Psychiatry, Child & Adolescent Psychiatry and Mental Health, Alcohol & Drugs Program - PALPAD, Sao Paulo, Brazil

Parker J. Holman, Student Representative; MS, MSED, PhD Candidate, Graduate Program in Neuroscience, University of British Columbia, Vancouver, BC, Canada

Sarah Inkelis, Student Representative; BA, PhD Student, SDSU/UCSD Joint Doctoral Program in Clinical Psychology, San Diego State University, San Diego, CA, USA

Denis Lamblin, PhD, Pediatrician, President, SAFFRANCE; Delegate Director for Local Networks and Regional, National and International Relations, FASD Resource Center, Père Favron Foundation, Reunion Island, France

Hae Kook Lee, MD, Department of Psychiatry, Uijeongbu St. Mary's Hospital; College of Medicine, The Catholic University of Korea, Seoul, Republic of Korea

Rebecca Martell, Clinical Associate, Occupational Performance Analysis Unit (OPAU), Department of Occupational Therapy, University of Alberta, Edmonton, AB, Canada

Philip A. May, PhD, Research Professor, Gillings School of Global Public Health, University of North Carolina at Chapel Hill-Nutrition Research Institute, Kannapolis, NC, USA

Michelle Sherbuck, Parent, Advocate and Communications Professional, dba Write and Design, Surrey, BC

Marsha Wilson, MA, Leadership, Faculty Member, Douglas College, New Westminster, BC

Valerie McGinn, PhD, Clinical Neuropsychologist, The FASD Centre, Aotearoa, New Zealand

Mansfield Mela, MBBS, FWACP, FRCPsych, MSc, FRCP, Professor, Department of Psychiatry, University of Saskatchewan, Saskatoon, SK, Canada

Raja A.S. Mukherjee, MBBS, FRCPsych, PGDIP EPP, PhD, Consultant Psychiatrist, Tandridge CITPLD; Lead Clinician, FASD Specialist Clinic and Adult Autism Diagnostic Services, SABB NHS Foundation Trust, London, UK

Moirá Plant, PhD, Emeritus Professor of Alcohol Studies, Alcohol & Health Research Unit, University of the West of England, Bristol, UK; Adjunct Professor, Curtin University, Perth, Australia

Lina Schwerg, BSc, Student Representative; Master Student, Department of Psychology, University of Potsdam; Assistant Manager of the FASD-Fachzentrum Sonnenhof, Berlin, Germany

Paula Stanghetta, Facilitator, Coach, Trainer, Paula Stanghetta & Associates, Kitchener, ON, Canada

Kenneth R Warren, PhD, Senior Advisor for Operations, FASD and Science, National Institute on Alcohol Abuse and Alcoholism, National Institutes of Health, Bethesda, MD, USA

Local Planning Committee

Anne Fuller, RN, MSN, Provincial FASD Consultant, Children and Youth with Special Needs Policy, Ministry of Children and Family Development, Government of British Columbia, Victoria, BC

Cheryl McIntee, CPCA-RPC, MPCC, Master Practitioner Clinical Counsellor, Cheryl McIntee Counselling and Consulting, White Rock, BC, CDBC/FASD Keyworker, FASD Collaboration Roundtable, Touchstone Family Association, Richmond, BC

Kee Warner, Executive Director, Whitecrow Village FASD Society, Nanaimo, BC

EXHIBITOR LISTING

The Asante Centre

The Asante Centre is committed to supporting individuals of all ages with neurodevelopmental impacts, and their families, to reach their full potential. We do that through quality assessment and diagnostic services, speech-language therapy, client and family support, education, resource access and development, peer mentorship, and research. We specialize in brain-based disabilities such as FASD, autism spectrum disorder (ASD), and other complex disorders influenced by a range of early trauma, prenatal stress, mental health, or genetics.

BC Children's Hospital Research Institute

BC Children's Hospital conducts discovery, translational and clinical research to benefit the health of children and their families. We are supported by BC Children's Hospital Foundation and work in close partnership with the Provincial Health Services Authority, its agencies, the University of British Columbia. We will be sharing information about upcoming FASD research studies happening BC Children's Hospital Research Institute. We are very excited to be launching a new study focusing on adults with FASD and their overall health and wellbeing.

Canada Revenue Agency

We offer a variety of resources that cover general tax and benefit information, as well as resources that offer specific information for people with disabilities, youth/students, seniors, newcomers, and Indigenous peoples.

CanFASD

CanFASD is Canada's first comprehensive organization to support the country's leadership in addressing the extraordinary complexities of FASD. CanFASD works with member provinces, researchers and policy-makers to develop and promote evidence-based information to move the FASD agenda forward in Canada. Our mission is to produce national, multidisciplinary, collaborative research that can be shared with all Canadians, leading to prevention strategies and improved outcomes for people affected by FASD.

College of Extended Learning University of New Brunswick

UNB's College of Extended Learning (UNB CEL) has provided Autism, FASD and Behaviour Intervention Training Program to over 1200 clinical supervisors, consultants, educational assistants and support workers in the province of New Brunswick, Saskatchewan and France. UNB continues to grow its offerings in Autism, FASD and Behaviour Intervention with research and support.

FASD Communities

FASD Communities is a registered 501(c)3 not-for-profit organization dedicated to providing supportive housing, vocational opportunities and life skills to young adults across the U.S. affected by fetal alcohol spectrum disorders (FASD). Our team of volunteers has unparalleled expertise in education, business, finance, communications and healthcare—but our real credentials are as parents or close friends of this population. After years of safety and stability at home, we have watched too many of our children end up on the streets, chronically unemployed, in trouble with the law and victimized as they struggle in their transition to adulthood.

Institute of Health Economics

The Institute of Health Economics (IHE) is an independent, not-for-profit organization that conducts research in health economics and health technology assessment to assist health policy making and best medical practices. IHE has extensive experience conducting work in the field of addictions and mental health. Our efforts span from hosting major knowledge sharing and awareness events, to producing excellence in research and evaluation with researchers from across Canada. For more information, visit us at www.IHE.ca.

Lakeland Centre for FASD

The Lakeland Centre For Fetal Alcohol Spectrum Disorder (LCFASD) is a not-for-profit organization with offices throughout northeast Alberta to provide a helping hand to people at any age or stage of life. Since 1994, the LCFASD has been on the forefront of providing lifelong care for children and women affected by substance use during pregnancy. From birth through to adulthood, we're there educating, nurturing and supporting people from all walks of life. LCFASD provides education & training, diagnosis, intervention services and prevention with our 2nd Floor Women's Recovery Centre.

Ministry of Child and Family Development

MCFD is looking for people like you to become foster parents – people who are working in/connected to the community and who seek out opportunities to develop their knowledge base and skills. We have an immediate need for caregivers who are willing to foster children of all ages. However, we have an urgent need for caregivers skilled in working with: children/youth with special needs (respite as well as full time caregivers), adolescents and young children.

NTI Upstream

NTI Upstream is a multimedia production and publishing company dedicated to advancing the conversation about the issues of health and social welfare. We specialize in producing resources that focus on the healthy development of children and their families.

ODIN Books

ODIN BOOKS is an independently owned, specialty bookstore. We provide mental health, education, and psychology-based resources to communities, organizations, schools, and individuals. We stock a wide selection of FASD specific and related resources to support individuals, families and professionals. With books, games, sensory tools, visual and audio resources sourced from across North America and around the world, we're a one-stop solution for busy professionals who need to spend budget money wisely within specific deadlines.

Office of the Representative for Children & Youth

Since 2007, British Columbia's Representative for Children and Youth has supported our province's young people and their families in dealing with the provincial child and youth welfare system. The Representative also provides oversight to this system and makes recommendations to improve it. The Representative is a non-partisan, independent officer of the Legislature, reporting directly to the Legislative Assembly and not a government ministry.

The Uganda Serenity Centre

The Uganda Serenity Centre is Uganda's pioneer Centre for alcoholics and substance abuse. They will have documentaries on FASD management in Uganda, and talk about national and project research and survey reports on FASD in Uganda.

Vancouver Native Housing Society - Skwachays Hotel and Gallery

The mission of Vancouver Native Housing Society is to provide safe, secure, affordable housing for Aboriginal individuals and families living in the urban setting. We will showcase West Coast indigenous art, jewelry, carvings and gift ware. Supporting the Social Enterprise and Artist in Residence Programme of Skwachays. Original works by west coast artists.

Resource Table

Family Support Institute Centres for Disease Control and Prevention



CONVENTION LEVEL | 3RD FLOOR

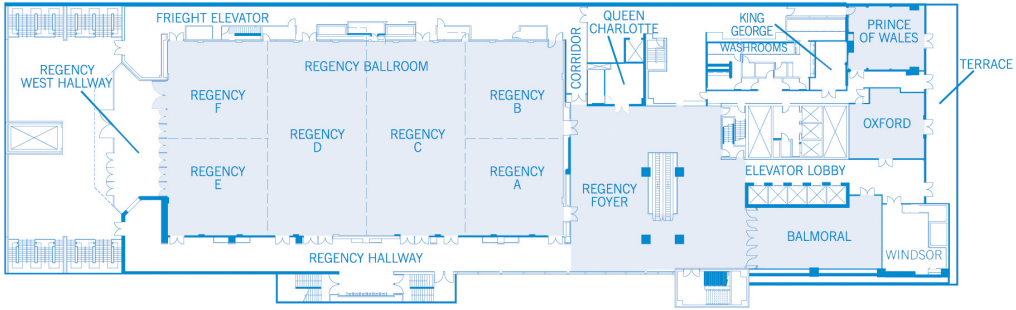

PLAZA LEVEL | 2ND FLOOR

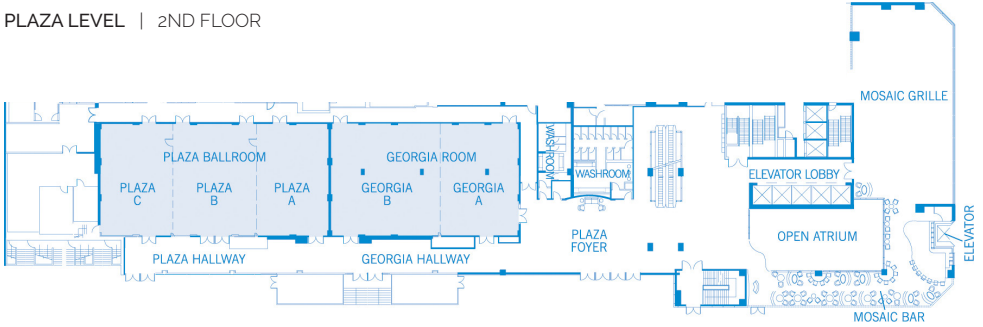

PERSPECTIVES LEVEL | 34TH FLOOR

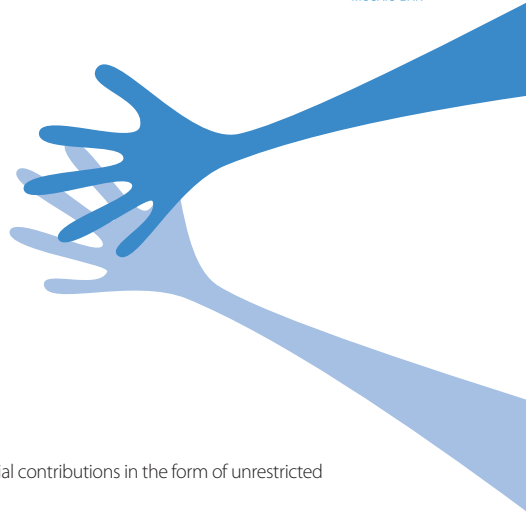
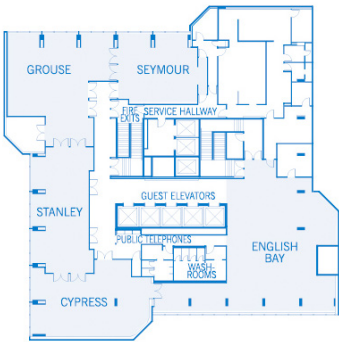

ACKNOWLEDGEMENTS

We would like to acknowledge with great appreciation the financial contributions in the form of unrestricted educational grants from the following organizations:

Gold Sponsors



Silver Sponsor



Bronze Sponsors

